

# R65t

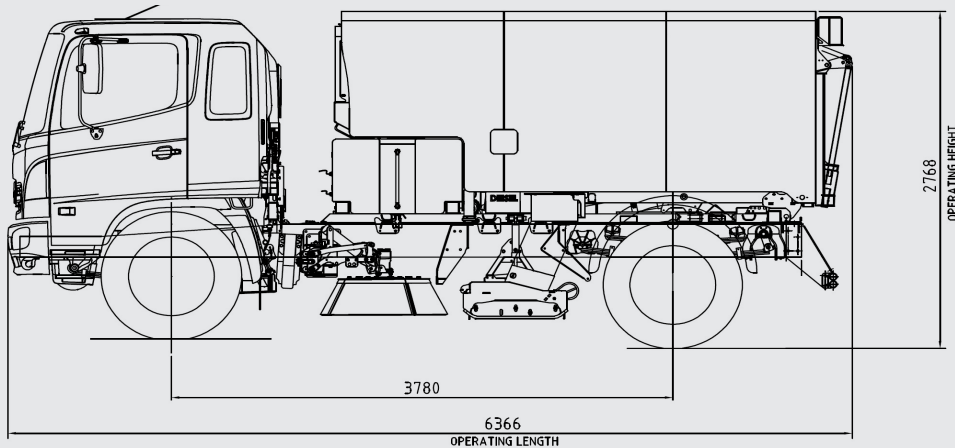

## Dimensions and weight\*

Length	6366 mm
Width	2500 mm
Height	2768 mm
Wheelbase	3780 mm
GVW	14000 / 15500 kg
Payload	4000 kg

## Auxiliary engine

Engine	JCB Dieselmex 444-85kw@2200rpm
Emission rating	Stage 3a
Noise rating	105 dBa LBA
Operating RPM	1200-2000rpm variable
Fuel tank	220l (shared with cab chassis)

## Body

Material	4mm 4003 stainless steel
Volume	6.5m <sup>3</sup>
Discharge angle	55 degrees
Safety	automatic body prop
Controls	wireless pendant

## Water system

Capacity	900l
Nozzle trunk water injection**	two
High pressure water	100bar pump
High pressure hand lance	15 m hose
PM rating	PM2.5/10

## Sweeping and suction

Channel brushes*	ø1000mm
Pickup hood width	2250mm
Trunk diameter	ø350mm
Optimal sweeping speed	2-16 km/h
Sweeping width	Up to 3500 mm

\* Approx/ Chassis dependent

\*\* Low pressure nozzles for dust suppression

+ Lateral extension and tilting brush head

## R65t Australian design for the local market

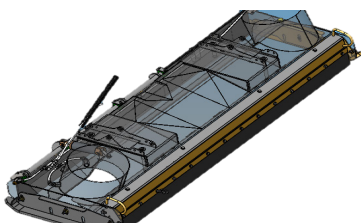

### Pick up hood

Our specially designed full width pick up hood offers best in the market performance thanks to its "air blade" system which cuts through stubborn dirt, agitating the smallest debris before being sucked up through its large 350mm intake duct, leaving nothing behind.



### JVM Control

Centrally mounted 7" JVM display and clearly labeled buttons will ensure constant monitoring of the performance, water, oil and fuel levels as well as selected options. Installed on a pivoting base, the JVM screen can be viewed whilst operating from either driving position.

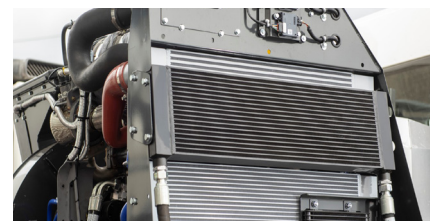

### JCB Engine

The powerful 85kW JCB engine and mechanically connected suction fan ensures best suction performance whilst caring about the environment with EU regulated stage 3a emission rating.

# R65t

---

## Safety

Full OH&S compliance. Tailgate safety check valve & automatic body safety prop. Safety decals with clear labels around hazardous components on the machine.

## Lighting

Multiple LED work lights fitted around the machine will ensure constant visibility in darker conditions. Standard LED beacons will also ensure safety of the operators and public.

## Sweeping gear

R65t is equipped with two, large 1000mm diameter, steel curb brushes with hydraulically operated lateral extension capable of maximum sweeping width of 3500mm. The ability of extension and retraction of the brush allows for faster and more efficient sweeping performance, especially in the tighter areas of the sweeping path.

Standard brush tilt on the left hand side (and optional on the right hand side) will allow operator to position the brush for optimum sweeping performance, regardless of surface profile.

Both curb brushes are easily operated from Bucher's ergonomic control system which controls brush rotation speed as well as pressure and brush water sprays

## Pick up hood

Spring suspended and hydraulically operated full width pick up hood ensures constant connection with the surface creating a perfect seal which results in maximum suction performance. Bucher's unique design, which we call "Air Blade", allows the most stubborn dirt and the smallest particles to be blasted off the surface, agitated within the hood and sucked right up. Pickup hood width of 2250mm with hydraulically operated large debris flap will collect anything in its path - from larger objects such as bottles to large volume debris such as leaves.

## High pressure jet lance

Equipped as standard, R65t comes with high pressure pump rated at 100bar and high pressure jet lance with 15m retractable hose reel.

## Wireless body control

Supplied as standard, the wireless body controller allows the operator to tip the load out of harm's way, 360 degree and up to 5 meters away from the sweeper.

Tip controls include tailgate operation, body raising and lowering as well as stowing the safety prop. This ensures safety of the operator and surroundings by having a constant view on the vehicle, from any angle and without any physical involvement from the operator.

## Body

6.5m<sup>3</sup> hopper and fabricated from 4mm 4003 stainless steel. Access doors fitted on both sides with a safety grab handle and step to allow for screen and body load inspection.

## Chassis availability

Bucher R65t is available on Hino and Isuzu cab chassis.

## Control system

The ergonomic in-cab controls and centrally mounted 7" CANBus screen allowing data capture, on-board diagnostics and in cab daily checks incorporate an audible and visual warning for sweeper fuel gauge, engine hour meter, tachometer and a low level water indicator as standard. Mounted on a pivoting base, the 7" screen can be viewed from either driving position.

## Standard options

- Work light: LED lamps on engine bay, brushes and reverse search lamps
- Front and rear LED beacon light
- Rotatilt function on left hand channel brush
- High pressure jet lance with high pressure and low pressure water function
- 12 months / 2500 hours warranty

A range of options are available – contact us for more information.

Subject to change without notice.

